

# CONTROLLER ASSEMBLIES

## RAIN BIRD® LX-IVM & IVM PRO DECODER CONTROLLER ASSEMBLY

The Imperial Controller Assembly (ICA) is built with the highest quality standards using UL Listed stainless steel enclosures to provide simple and efficient installations in the field. All Assemblies include a pre-installed controller(s), 120VAC receptacles, terminal boards for wiring and mounting instructions. The Imperial Assemblies wiring harness is wired through the rear giving it a clean look.

As pre-assembled and pre-wired for convenience, the installer is responsible for setting the enclosure base (or Mounting Pad), installing conduits, wiring the 120VAC electrical to the receptacle, and connecting the valve wires to the terminal board. Optional flow, rain, and other sensing devices may also be connected to the terminal board.

Mounting bases (#MP) are ideal way to further reduce installation time by eliminating the need to a pour concrete base. All Imperial Assemblies include a limited 5 year warranty.



### SPECIFICATIONS

The Imperial Controller Assembly shall include a UL Listed stainless steel vandal resistant enclosure with a removable backboard, 120VAC outlet receptacle, and terminal wire board with Remote Receiver Connector (RRC).

The electrical junction box shall include an on/off power switch and duplex receptacle with ground fault interrupt circuit.

The terminal wiring board shall be pre-mounted and wired through the rear side of the backboard and shall include screw-less cage-type terminal block connections including up to two slots per terminal and may accept 12 or 14 gauge AWG wires. The terminal board shall also include a reset-able fuse and sensor bypass switch.

The terminal board(s) shall have a maximum of forty eight (48) valve station locations including additional terminals for up to four (4) common wires, master valve(s), two (2) rain sensor terminals, pump start, flow sensor, and two-wire communication cables.

### STRONG BOX ENCLOSURE TYPES

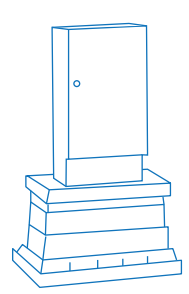
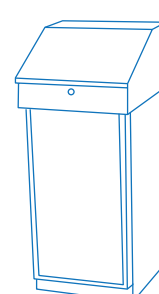
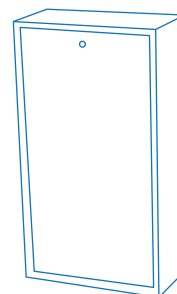
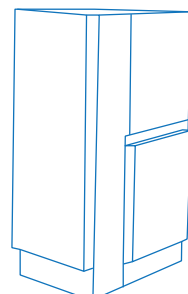
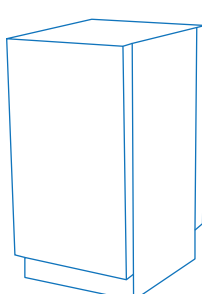
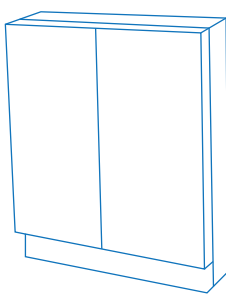
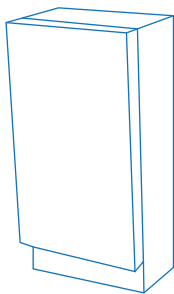

SINGLE  
CABINET

SIDE BY  
SIDE

DOUBLE  
WIDE

METER  
CONTROLLER

LITE  
CONTROLLER

TOP  
ENTRY

MOUNTING  
PAD

## RAIN BIRD® ESP-LX-IVM & IVM PRO CONTROLLER ASSEMBLY PART NUMBERING GUIDE

### Imperial Controller Assembly Part Number

### ICAX-RB8-XX+XX/Options

#### ICAX- Specify Strong Box Stainless Steel Enclosure Type

#### FRONT ENTRY

1=	18"W x 36"H x 12"D	SB18-SS PEDESTAL
2=	18"W x 36"H x 24"D	SB18D-SS PEDESTAL
3=	24"W x 36"H x 12"D	SB24-SS PEDESTAL
4=	24"W x 36"H x 24"D	SB24D-SS PEDESTAL
8=	36"W x 36"H x 12"D	SB36-SS PEDESTAL

#### ELECTRIC METER/ CONTROLLER ENCLOSURE

5A=	18"W x 52"H x 20"D + 18"W x 52"H	SB-1852SS PEDESTAL	(100/100 AMP – 1 PH)
5B=	18"W x 52"H x 20"D + 18"W x 52"H	SB-1852SS PEDESTAL	(100/150 AMP – 1 PH)
5C=	18"W x 52"H x 20"D + 18"W x 52"H	SB-1852SS PEDESTAL	(100/200 AMP – 1 PH)
5D=	18"W x 52"H x 20"D + 18"W x 52"H	SB-1852SS PEDESTAL	(100/100 AMP – 3 PH)
5E=	18"W x 52"H x 20"D + 18"W x 52"H	SB-1852SS PEDESTAL	(200/200 AMP – 3 PH)

#### TOP ENTRY ENCLOSURES

6=	16"W x 38"H x 15.5"D	SB-16SS PEDESTAL
7=	24"W x 38"H x 17"D	SB-22SS PEDESTAL

#### WALL MOUNT ENCLOSURES AND BACKBOARDS

10=	16"W x 32"H	BACKBOARD – WALL MOUNT
11=	22"W x 32"H	BACKBOARD – WALL MOUNT
16=	18"W x 36"H x 12"D	SB-18SSW WALL MOUNT ENCLOSURE
17=	24"W x 36"H x 12"D	SB-24SSW WALL MOUNT ENCLOSURE

#### LITE DUTY ENCLOSURES

12=	16.75"W x 30"H x 8.25"D	LD-16SW WALL MOUNT
13=	16.75"W x 30"H x 8.25"D	LD-16SSW PEDESTAL
15=	17 1/2"W x 34 1/2"H x 11 1/2"D	LD-16 TOP ENTRY PEDESTAL

### RB8-XX+XX /OPTIONS

<b>RB8</b>	<b>CONTROLLER MANUFACTURER</b> RB = Rain Bird
<b>RB8</b>	<b>CONTROLLER TYPE/COMMUNICATION</b> 1 = OMIT 2 = ESP-LXME2 3 = ESP-LXMEF2 PRO 4 = OMIT 5 = ESP-LXD 6 = ESP-LX Basic 7 = ESP-ME3 8 = LX IVM & IVM PRO
<b>XX</b>	<b>CONTROLLER #1 STATION QUANTITY (60 &amp; 240 Only)</b>
<b>+XX</b>	<b>CONTROLLER #1 STATION QUANTITY (60 &amp; 240 Only)</b>
<b>/OPTIONS</b>	<b>CONTROLLER OPTIONS</b> (See Controller Assembly Options Section for available options)